

HYDROTECH MINI / MEDIUM 03 SQUARE LED

COD 706006

COD 706007

ASSEMBLY AND OPERATING INSTRUCTIONS:



-class I luminaire with built-in transformer 220-240V 50-60Hz
-apparecchio in classe 1 con trasformatore incorporato a 220-240V 50-60Hz
-Leuchten Klasse 1 mit internen Transformator 220-240V 50-60Hz
-Classe 1 luminaire avec transformateur intégré 220V-240V 50-60Hz

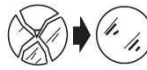

-replace the damaged protective glass
-sostituire i vetri di protezione se danneggiati
-die Beschädigten Schutzgläser ersetzen
-remplacer les verres de protection abimés
-glass features: plane float glass - safety tempered
-caratteristiche vetro: vetro piano float di sicurezza temperato
-Glaseigenschaften: Float-Flachglas, gehärtetes Sicherheitsglas
-caractéristiques du verre: type de verre: plan" float" de sûreté trempé



-getting rid of as urban waste forbidden
-separate collection is mandatory when the product is at the end of its life

-è vietato lo smaltimento come rifiuto urbano
-è obbligatoria la raccolta separata a fine vita del prodotto

-Das Entsorgen im Hausmüll ist verboten!
-Bei Ablauf der Lebensdauer bitte beachten:
-Abfalltrennung ist Pflicht

-il est interdit l'élimination comme ordure urbaine
-le ramassage séparé est obligatoire lorsque le produit est à la fin de sa vie

IP65



Made in Italy

NB: These assembly instructions must be given to end users for correct maintenance and so that they know how to change the bulb. The appliance must not be tampered with or transformed and it must be installed and used as supplied and in compliance with the National Rules on Installations. Any non-compliant installations will invalidate all forms of guarantee. The company cannot be held responsible for damage caused by incorrect assembly.

NOTA BENE: Le presenti istruzioni di montaggio devono obbligatoriamente essere consegnate all'utente finale affinché conosca le corrette modalità di manutenzione e ricambio lampada. È vietata qualsiasi manomissione e/o trasformazione dell'apparecchio che deve essere installato e utilizzato: così come fornito e in conformità alle Norme Impianti Nazionali. Installazioni non conformi fanno decadere ogni forma di garanzia, l'Azienda non risponde dei danni causati da un errato montaggio.

N.B. Vorliegende Montageanleitungen müssen auf jeden Fall dem Endverbraucher übergeben werden, damit dieser über die korrekten Wartungs- und Lampenaustauschmodalitäten informiert ist. Jegliches Aufbrechen und/oder Änderung der Leuchte ist verboten. Die Leuchte muss wie geliefert und entsprechend den anlagentechnischen Landesvorschriften montiert und verwendet werden. Nichtentsprechende Installationen führen zum Verfall von jeglicher Garantie. Das Unternehmen übernimmt keine Verantwortung für Schäden, die durch fehlerhafte Montage verursacht sind.

N.B.: Remettre obligatoirement ces instructions de montage à l'utilisateur final pour qu'il connaisse les modalités correctes de maintenance et de remplacement d'ampoule. Toute modification et/ou transformation est interdite sur l'appareil, qui doit être installé et utilisé tel qu'il est fourni et conformément aux Normes d'Installation Nationales. Une installation non conforme provoque la déchéance de toutes formes de garantie et la compagnie ne répondra pas des dommages provoqués par un montage erroné.

COD. 706006

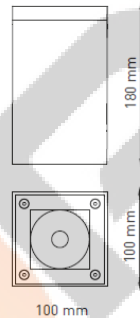

HYDROTECH MINI 03 SQUARE LED

-Power consumption : 13W
-Voltage :220-240V 50-60Hz
-Color Temperature : 3000K
-Beam angle : 30°
-Lumen output 1290Lm
-Insulation class: I
-IP protection: IP65
-Gross weight: 1.15kg

COD. 706007

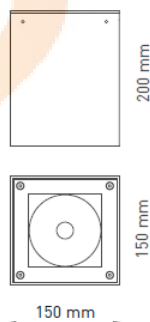

HYDROTECH MEDIUM 03 SQUARE LED

-Power consumption : 26W
-Voltage :220-240V 50-60Hz
-Color Temperature : 3000K
-Beam angle : 30°
-Lumen output 2500Lm
-Insulation class: I
-IP protection: IP65
-Gross weight: 2.5kg

Installation:

CAUTION: Possibly hazardous optical radiation emitted from this product. Do not stare at operating lamp. May be harmful to the eye. The replacement must be done by a qualified electrician.

Recommendations

- 1) verify that the equipment used to connect our devices to enjoy all the guarantees required under European law;
- 2) use the cables, connectors and quality materials for electrical wiring;
- 3) Products with IP65/68 degree make the wiring / connections with accessories provide the same degree IP of the selected product (available in the catalog);
- 4) Disconnect main voltage during installation and maintenance
- 5) It is essential to do a frequent cleaning of the glass and of the outer surface of the fixture to avoid build up of mud and dirtiness resulting in dangerous overheating due to uncorrect light and heat dissipation. Clean carefully the glass screen removing limestone deposits by means of a scraper.

HYDROTECH MINI 03 SQUARE LED INSTALLATION

1

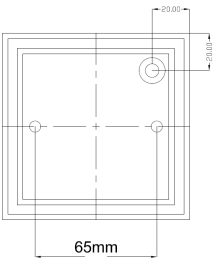

-Drill holes in the wall using plastic dowels included in the package

2



-open the luminaire base using the tool (included in the package) by uncrewing nr 4 hexagonal head screws

3

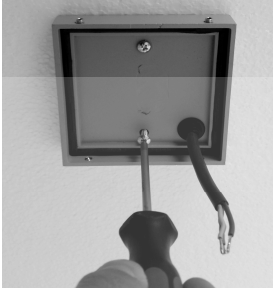

-insert the power cable through the cable clamp and fix the base to the wall

4



-making the connection with the electric clamp (L-N-PE)

5



-close the the luminaire directly un the base. check the coupling with holes, being careful that the silicon gasket is positioned correctly

6

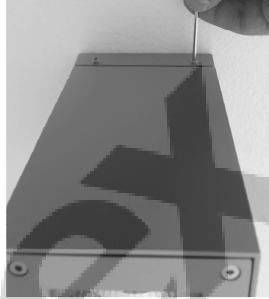

-tighten the hexagonal head screws to close the luminaire.

HYDROTECH MEDIUM 03 SQUARE LED INSTALLATION

1

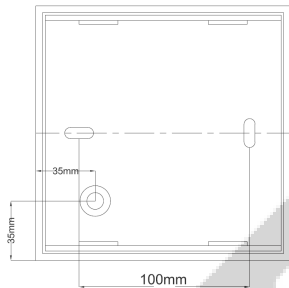

-Drill holes in the wall using dowels included in the package

2

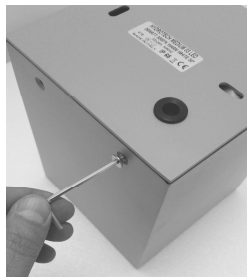

-open the luminaire base using the tool (included in the package) by uncrewing nr 4 hexagonal head screws

3

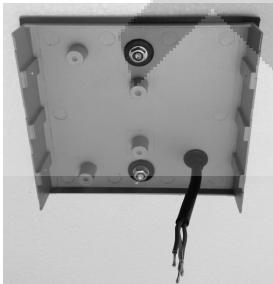

-insert the power cable through the cable clamp and fix the base to the wall

4

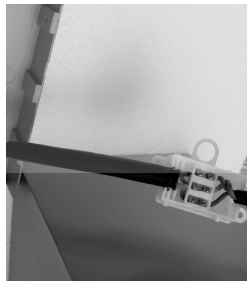

-making the connection with the electric clamp (L-N-PE)

5



-close the the luminaire directly un the base. check the coupling with holes, being careful that the silicon gasket is positioned correctly

6



-tighten the hexagonal head screws to close the luminaire.