

SCOUT MINI SCOUT MEDIUM

-COD. 601901

-COD. 601902

ASSEMBLY AND OPERATING INSTRUCTIONS:



-Class I fitting electric grounding is needed



In the case of glass breakage, contact the device manufacturer to replace it. Replace the screen with an original replacement



-getting rid of as urban waste forbidden
-separate collection is mandatory when the product is at the end of its life



Made in Italy

IP65



- GB Retain the instructions.
- I Conservare le istruzioni.
- D Retain the instructions.
- F Bewahren Sie die Anleitung.
- E Conservez ces instructions.

NB: The appliance must not be tampered with or transformed and it must be installed and used as supplied and in compliance with the National Rules on Installations. Any non-compliant installations will invalidate all forms of guarantee. The company cannot be held responsible for damage caused by incorrect assembly.

COD. 601901



SCOUT MINI

- Power consumption 4W
- Voltage : 220-240V 50-60Hz
- Color Temperature : 3000K - 4000K
- Beam angle : 180°
- Insulation class: I
- IK rating : IK08
- IP protection: IP65
- Gross weight: 4.5kg

COD. 601902

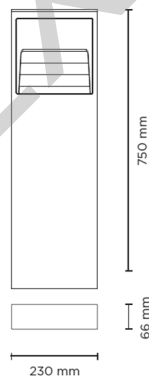

SCOUT MEDIUM

- Power consumption 8W
- Voltage : 220-240V 50-60Hz
- Color Temperature : 3000K - 4000K
- Beam angle : 180°
- Insulation class: I
- IK rating : IK08
- IP protection: IP65
- Gross weight: 7 kg

Recommendations

- 1) verify that the equipment used to connect our devices to enjoy all the guarantees required under European law;
- 2) use the cables, connectors and quality materials for electrical wiring;
- 3) Products with IP65 degree make the wiring / connections with accessories provide the same degree IP of the selected product (available in the catalog);
- 4) In the case of installations outside is not recommended to install the power supplies in the formwork and / or in the junction box without adequate protection

Note on corrosion protection

For installation and maintenance be especially careful not to damage the coating powder . Damage combined action of water could cause corrosion.

-In the case of damage to the external flexible cable, it must be replaced by the manufacturer, or its assistance service, or equivalent qualified personnel in order to avoid dangers

-In the case of glass breakage, contact the device manufacturer to replace it. Replace the screen with an original replacement

-Terminal block not included. Installation may require advice from a qualified person. For wiring use a terminal complies with EN60998-2-1, EN 60998-2-2. The IP rating of the electrical connection must be equal to or greater than the IP rating of the luminaire.

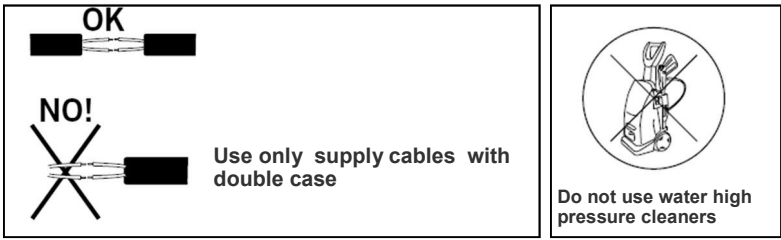

Installation

1. Loose 4 screws in the base of the luminaire and remove the fixing plate pic. 1
2. Prepare holes in corrspondance of the feeding point using fischer plugs pic. 2
3. Fix the base to the floor by tighten the screws of the fischer plugs pic. 3
4. Insert the cable through the base hole pic. 4
5. Make the adeguate electrical connection pic. 5
6. Place the luminaire by tighten the four screws using the tool included in the package pic. 6

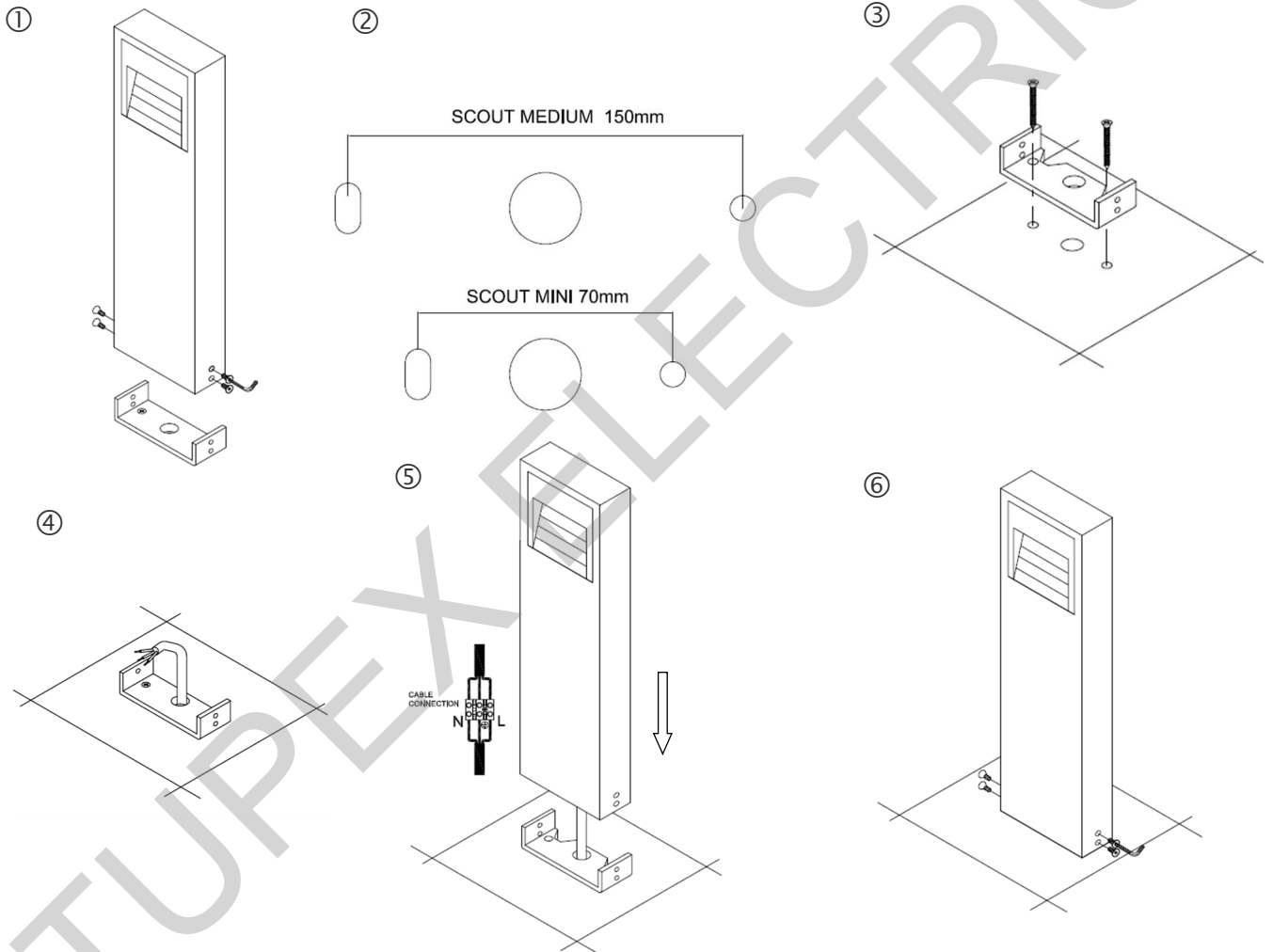

CLASS I

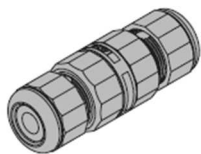

See the connector accessory instruction

L	<p>Life / Linea / Leitung Ligne / Linea / Fas Fase / Фаза / Vaihe Linha</p>	<p>Brown / Marrone / Braun Brun / Marrón / Brun Bruin / коричневый / ruskea Marrom</p>
N	<p>Neutral / Neutro / Null Neutre / Neutro / Nolla Nul / Ноль / Nolla Neutro</p>	<p>Blue / Blu / Blau Bleu / Azul / Blå Blauw / синий / Sininen Azul</p>
	<p>Earth / Terra / Erde Terre / Tierra / Jord Aarde / Земля / Suojamaa Terra</p>	<p>Yellow-Green / Giallo-Verde / Gelb-Grün Jaune-Vert / Amarillo-Verde / Gul-Grön Geel-Groen / Желто-зеленый Keltainen-Vihreä / Amarelo-Verde</p>