

POOL MINI-MEDIUM-MAXI-MEGA

COD. 303001
 COD. 303002
 COD. 303003
 COD. 303004

ASSEMBLY AND OPERATING INSTRUCTIONS:



-very low voltage feeding with security transformer
 -Class III no earth required

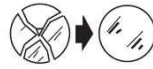

-replace the damaged protective glass
 -glass features: plane float glass - safety tempered



-getting rid of as urban waste forbidden
 -separate collection is mandatory when the product is at the end of its life

IP68

-totally dust-proof indefinite submerged operation - max allowed depth 1m



Made in Italy

IK 09

NB: These assembly instructions must be given to end users for correct maintenance and so that they know how to change the bulb. The appliance must not be tampered with or transformed and it must be installed and used as supplied and in compliance with the National Rules on Installations. Any non-compliant installations will invalidate all forms of guarantee. The company cannot be held



Retain the instructions

COD. 303004

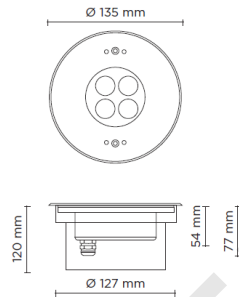

POOL MINI

- Power consumption (nr. 4LED's): 8W
- Voltage :24 Vdc
- Color Temperature : 3000K
- Lumen output: 415 lm
- Lens Type : 30°
- Insulation class: III
- IP protection: IP68 max 1mt depth
- Gross weight: 1.3kg

COD. 303001

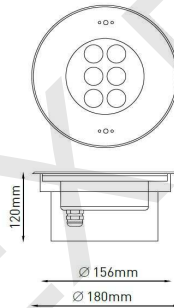

POOL MEDIUM

- Power consumption (nr. 6LED's): 12W
- Voltage :24 Vdc
- Color Temperature : 3000K
- Lumen output: 1200lm
- Lens Type : 30°
- Insulation class: III
- IP protection: IP68 max 1mt depth
- Gross weight: 2kg

COD. 303002

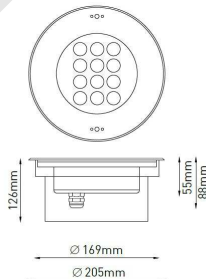

POOL MAXI

- Power consumption (nr. 12LED's): 24W
- Voltage :24 Vdc
- Color Temperature : 3000K
- Lumen output: 2000lm
- Lens Type : 30°
- Insulation class: III
- IP protection: IP68 max 1mt depth
- Gross weight: 2.5kg

COD. 303003

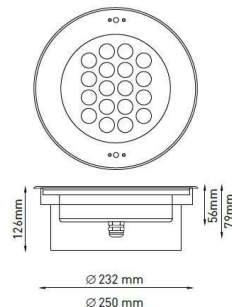

POOL MEGA

- Power consumption (nr. 18LED's): 36W
- Voltage :24 Vdc
- Color Temperature : 3000K
- Lumen output: 2900lm
- Lens Type : 30°
- Insulation class: III
- IP protection: IP68 max 1mt depth
- Gross weight: 3,8kg

WARNING: THIS LUMINAIRE MUST BE USED ONLY UNDER WATER, THEREFORE CAN'T WORK OUT OF WATER

National safety regulations must be followed during installation. No liability will be accepted for improper use or fitting. No liability will be accepted in case of retrospective modification to the lights.

All fitting, installation and electrical work must be performed by qualified specialist staff.

-feeding must be done through a safety power (SELV) providing 24V DC stabilized secondary tension.

The floodlight is supplied by us with the led pre-installed and connected with 3 meters cable section 2x1mm² according CENELEC HD 22.16.S1 (for AD8 water submersion).

The cable and the fixture must not be tampered with for any reason.

-max. installation depth 1m.

Important information and maintenance:

-Before installation, all parts must be checked for transport damage!

-The relamping must be done with maximum attention avoiding to dirty the sealing gasket and its contact surface. It is therefore necessary before

-opening the fixture to carefully wipe the floodlight then unscrew the round frame by the proper key

-If the gasket is damaged, deformed or not in perfect conditions it is necessary to change it

-it is essential to do a frequent cleaning of the glass and of the outer surface of the fixture to avoid build up of mud and dirtiness resulting in dangerous overheating due to uncorrect light and heat dissipation. Clean carefully the glass screen removing limestone deposits by means of a scraper.

-Do not use high pressure cleaners

-Protect spotlights from freezing; if appropriate, they may need to be dismantled or specially protected

-Lost screws or nuts may only be replaced by screws from V4A

-Depending on load (wattage) and water quality, we recommend changing the seals (on the glass pane, fitting, O-ring) and cable every 5-8 years.

The cable length of the lights should be chosen in such a way that it is not necessary to extend in water or moist environments. Later complaints resulting from this cannot be accepted.

-Only use stainless steel tools to avoid external rust!

-The operating devices must be connected without power, as otherwise discharges in the power supply may cause the LED to be damaged. No primary voltage may be applied when changing the LED.

-Note polarity when changing the lights! The wrong polarity can damage the LED module

-It is recommended that the customer install an overvoltage protection in accordance with DIN VDE 0100-443, DIN VDE 0100-534 and EN 62305.

-Install the polypropylene recessing housing in the concrete keeping the edge flush with the wall

-Connect the formwork to the corrugated tube

-Insert the cable through the pipe

-Making the connections to the driver respecting the polarity

-Insert the luminaire in the formwork and fix it by tighten the fixing screws

