

HYDROECLIPSE MEDIUM SQUARE 01 02 LED

COD. 401707

COD. 401708

Made in Italy

ASSEMBLY AND OPERATING INSTRUCTIONS:

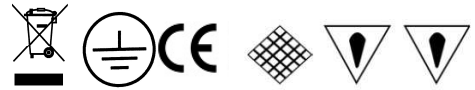

COD. 401707

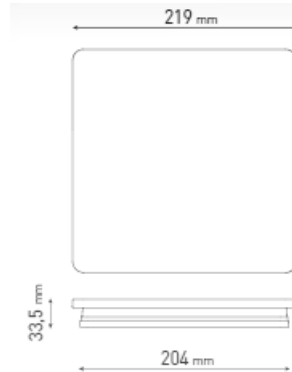

HYDROECLIPSE MEDIUM SQUARE 01 LED

- Power consumption : 10W
- Voltage : 220/240V 50/60Hz
- Color Temperature : 3000K
- Light beam: 30°
- Insulation class: 1
- IP protection: IP65
- Gross weight: 1,5 Kg

COD. 401708

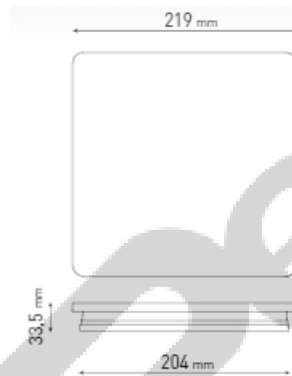
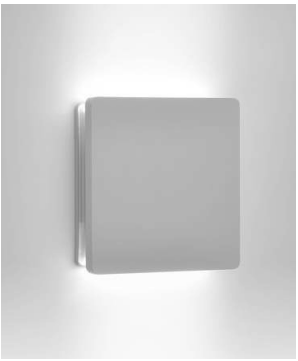

HYDROECLIPSE MEDIUM SQUARE 02 LED

- Power consumption: 19W
- Voltage : 220/240V 50/60Hz
- Color Temperature : 3000K
- Lens Type : 2X30°
- Insulation class: 1
- IP protection: IP65
- Gross weight: 1.5Kg

THE WARRANTY IS FALLING IN THE FOLLOWING CASES:

- 1) Malfunctions due to improper use of the product, modifications, repairs inadequate, negligence on the part of the installer / electrician, failure to assembly instructions and / or data plate;
- 2) Installations in plants not comply with the general safety;
- 3) Damage caused by natural causes such as lightning, fire or flooding;
- 4) Damage caused by wiring / connections with IP degree lower than the selected product.
- 5) Damage occurring during shipment of the product. In these cases the damage will be to charge and notify the carrier;
- 6) The warranty covers only the integrity of the product and NOT any costs of removal of the same;

Recommendations

- 1) verify that the equipment used to connect our devices to enjoy all the guarantees required under European law;
- 2) use the cables, connectors and quality materials for electrical wiring;
- 3) Products with IP67/68 degree make the wiring / connections with accessories provide the same degree IP of the selected product (available in the catalog);
- 4) In the case of installations outside is not recommended to install the power supplies in the formwork and / or in the junction box without adequate protection;

Choice of installation location

The unit should be positioned so that when in use is not subject to direct radiation from the sun or other heat sources . High temperatures reduce the life and efficiency of the components or the LED module .

-SWITCH-OFF THE POWER SUPPLY BEFORE CARRYING OUT ANY MAINTENANCE OPERATION

- 1) Open the luminaire by pushing the cover and move it out of the fixing springs (pic.1)
- 2) Drill 2 holes in the fixing and feeding point using an appropriate plug like fisher (not included in the package) (pic.2)
- 3) Making the appropriate electrical connection (L-N-PE)

- 1) Fix the base of the luminaire tightening the screws

- 2) Close the luminaire by insert the cover by pushing and move to lock it to the base

The luminaire is supplied by us with LED illuminator already installed with built in SELV power supply.

The cable and the fixture must not be tampered with for any reason.

-it is essential to do a frequent cleaning of the glass and of the outer surface of the fixture to avoid build up of mud and dirtiness resulting in dangerous overheating due to uncorrect light and heat dissipation. Clean carefully the glass screen removing limestone deposits by means of a scraper.

The replacement must be done by a qualified electrician

1

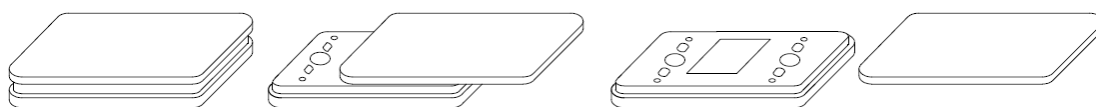

2

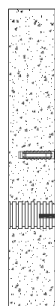
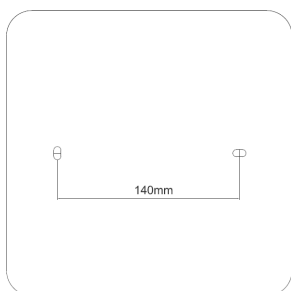

3

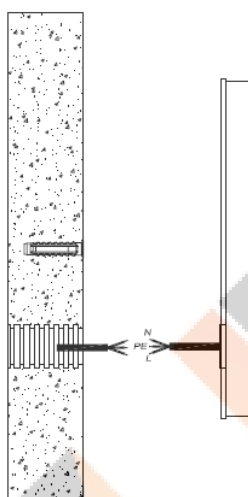

4

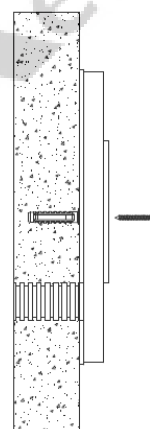

5

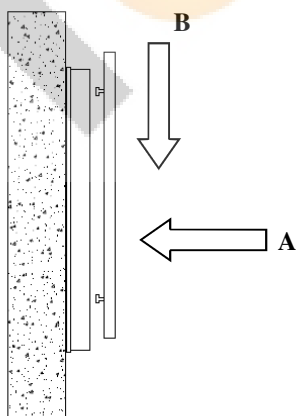

6

