

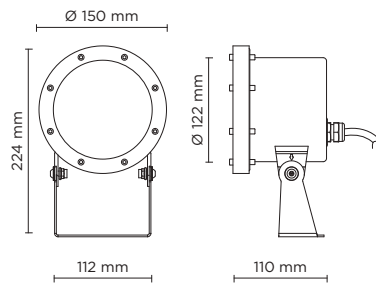



305003

DIVE MAXI

Underwater projector, surface mounted, completely made in stainless steel AISI 316L, silicone gasket, 24V DC remote driver needed, with 1 x COB LED. IP 68 rating.



THIS LUMINAIRE IS SUITABLE ONLY FOR UNDERWATER INSTALLATION

| light source | light beam options | lumen output (lm) | lumin. efficacy (lm/w) |
|--------------------------|---|-------------------|------------------------|
| 3000°K warm-white | | | |
| cob led |  30° | 1.478 | 73.90 |

Finish color options:

Stainless Steel

remote driver selection

| brand | manufacturer code | type | watt | IP rate | numbers of fixtures |
|----------|-------------------|-------------------------|------|---------|---------------------|
| Meanwell | LPV-35-24 | constant voltage 24V DC | 35W | IP67 | 1 |
| Meanwell | LPV-60-24 | constant voltage 24V DC | 60W | IP67 | min 1 - max 2 |
| Meanwell | LPV-100-24 | constant voltage 24V DC | 120W | IP67 | min 1 - max 4 |

Technical features



Technical data

| | |
|---------------|--|
| Wattage | 20 WATT |
| IP Rating | IP68 - 1 METERS DEPTH |
| IK Rating | IK09 |
| Material | Completely made in stainless steel AISI 316 L marine grade |
| Light source | NR. 1x20W COB LED |
| Screws | Stainless steel |
| Remote driver | 24V DC NEEDED |
| Gasket | Silicone rubber |
| Glass | Tempered |
| Cable gland | PG11 Cable gland made copper with nickel-coated |
| Power cable | 3 mt. neoprene power cable included |
| Gross weight | 2,00 Kg |



